

.....

# CNC

.....

- ↘ CNC 25 T
- ↘ CNC 25 Q
- ↘ CNC 35 T
- ↘ CNC 35 T Up
- ↘ CNC 35 Q
- ↘ CNC 35 Q Up
- ↘ CNC 35 Top S
- ↘ CNC 35 Top L
- ↘ CNC 35 Mask
- ↘ CNC 35 Swing
- ↘ CNC 35 Swing Spot
- ↘ CNC 49 CL
- ↘ CNC 49 C2L
- ↘ CNC 49 C4L
- ↘ CNC 49 C180
- ↘ CNC 49 QL
- ↘ CNC 49 Q2L
- ↘ CNC 49 Q4L
- ↘ CNC 50 T
- ↘ CNC 50 T Up
- ↘ CNC 50 Top L
- ↘ CNC 50 Top 2L
- ↘ CNC 50 Swing
- ↘ CNC 50 Swing Spot
- ↘ CNC 99 CL
- ↘ CNC 99 C2L
- ↘ CNC 99 C4L
- ↘ CNC 99 C180
- ↘ CNC 99 C UP
- ↘ CNC 99 QL
- ↘ CNC 99 Q2L
- ↘ CNC 99 Q4L
- ↘ CNC 100 L
- ↘ CNC 100 2L
- ↘ CNC 100 UP
- ↘ CNC 100 CL
- ↘ CNC 100 C2L
- ↘ CNC 100 C-UP
- ↘ CNC 120 T
- ↘ CNC 150

# CNC

The range



## CNC 25

## CNC 35

## CNC 49

## CNC 50

pag. 102

pag. 106

pag. 112

pag. 116

<b>Caratteristiche</b> Characteristics Caractéristiques	$^{\circ}\text{C } 65^{\circ}$ MAX <b>500</b> KG MAX	$^{\circ}\text{C } 65^{\circ}$ MAX <b>500</b> KG MAX <b>1000</b> KG MAX	$^{\circ}\text{C } 53^{\circ}$ MAX <b>500</b> KG MAX <b>1000</b> KG MAX	$^{\circ}\text{C } 65^{\circ}$ MAX <b>450</b> KG MAX <b>500</b> KG MAX <b>2000</b> KG MAX
<b>Emissione</b> Emission Émission				
<b>Colore della luce</b> LED colour Couleur du LED	<b>N</b>   4000K <b>3</b>   3000K <b>2</b>   2700K <b>B</b>   Blue	<b>N</b>   4000K <b>3</b>   3000K <b>2</b>   2700K <b>B</b>   Blue	<b>N</b>   4000K <b>3</b>   3000K <b>2</b>   2700K	<b>N</b>   4000K <b>3</b>   3000K <b>2</b>   2700K
<b>Inclinazione ottiche</b> Optics Optique	<b>M</b>   30° <b>S</b>   15° <b>D</b>   Diff.	<b>S</b>   14° <b>M</b>   29° <b>L</b>   46° <b>D</b>   Diff.	-	<b>S</b>   13° <b>M</b>   24° <b>L</b>   53° <b>D</b>   Diff.
<b>Potenza</b> Output Puissance	<b>2 W</b> <b>180 LM</b>	<b>2 W</b> <b>180 LM</b>	<b>2 W</b> <b>240 LM</b>	<b>6,5 W</b> <b>650 LM</b>
<b>Alimentazione</b> Power supply Alimentation	<b>500 mA - 4.8 V</b> <b>12/24 V</b>	<b>500 mA - 4.8V</b> <b>12/24 V</b>	<b>24 V</b>	<b>500 mA - 14 V</b> <b>24 V</b>
<b>Forma</b> Shape Forme				



**CNC 99**

pag. 120



**CNC 100**

pag. 126



**CNC 120**

pag. 132



**CNC 150**

pag. 136

<p>°C 53°<sup>MAX</sup></p> <p>↓  <b>500</b> <sup>KG</sup> <sup>MAX</sup></p> <p>↓  <b>2000</b> <sup>KG</sup> <sup>MAX</sup></p>	<p>°C 50°<sup>MAX</sup></p> <p>↓  <b>280</b> <sup>KG</sup> <sup>MAX</sup></p> <p>↓  <b>2000</b> <sup>KG</sup> <sup>MAX</sup></p>	<p>°C 60°<sup>MAX</sup></p> <p>↓  <b>2000</b> <sup>KG</sup> <sup>MAX</sup></p>	<p>°C 58°<sup>MAX</sup></p> <p>↓  <b>2000</b> <sup>KG</sup> <sup>MAX</sup></p>
<p><b>N</b>   4000K</p> <p><b>3</b>   3000K</p> <p><b>2</b>   2700K</p>	<p><b>N</b>   4000K</p> <p><b>3</b>   3000K</p> <p><b>2</b>   2700K</p>	<p><b>N</b>   4000K</p> <p><b>3</b>   3000K</p> <p><b>2</b>   2700K</p>	<p><b>N</b>   4000K</p> <p><b>3</b>   3000K</p> <p><b>2</b>   2700K</p>
-	-	<p><b>S</b>   spot-25°</p> <p><b>M</b>   60°</p> <p><b>A</b>   Asymm.</p> <p><b>D</b>   Diff.</p> <p><b>B</b>   Blade</p>	<p><b>S</b>   12°</p> <p><b>M</b>   24°</p> <p><b>L</b>   32°</p>
<p><b>5 W</b></p> <p><b>470 LM</b></p>	<p><b>3 - 5 W</b></p> <p><b>215 - 430 LM</b></p>	<p><b>9 W</b></p> <p><b>1000 LM</b></p>	<p><b>20W</b></p> <p><b>2800 LM</b></p>
<p><b>24 V</b></p>	<p><b>700 mA - 3.10 V   700 mA - 6.20V</b></p> <p><b>220 - 240 V</b></p>	<p><b>700 mA - 12V</b></p> <p><b>12/24 V</b></p>	<p><b>600 mA</b></p>

# CNC

The range

## ↘ CNC 25



**CNC 25**  
T



**CNC 25**  
Q



**CNC 35**  
Q



**CNC 35**  
Q UP



**CNC 35**  
MASK



**CNC 35**  
SWING

## ↘ CNC 35



**CNC 35**  
T



**CNC 35**  
T UP



**CNC 35**  
TOP S



**CNC 35**  
TOP L



**CNC 35**  
SWING SPOT

## ↘ CNC 49



**CNC 49**  
CL



**CNC 49**  
C2L



**CNC 49**  
C4L



**CNC 49**  
C180



**CNC 49**  
QL



**CNC 49**  
Q2L



**CNC 49**  
Q4L

## ↘ CNC 50



**CNC 50**  
T



**CNC 50**  
T UP



**CNC 50**  
TOP L



**CNC 50**  
TOP 2L



**CNC 50**  
SWING



**CNC 50 SWING**  
SPOT

## ↘ CNC 99

Finto incasso.  
Surface mounted.  
Faux encastré.



**CNC 99**  
CL



**CNC 99**  
C2L



**CNC 99**  
C4L



**CNC 99**  
C180



**CNC 99**  
C UP



**CNC 99**  
QL



**CNC 99**  
Q2L



**CNC 99**  
Q4L

## ↘ CNC 100



**CNC 100**  
L



**CNC 100**  
2L



**CNC 100**  
UP

Incasso.  
Recessed.  
À encastrer.



**CNC 100**  
CL



**CNC 100**  
C2L



**CNC 100**  
C-UP

Finto incasso.  
Surface mounted.  
Faux encastré.

## ↘ CNC 120



**CNC 120**  
T

## ↘ CNC 150



**CNC 150**

# CNC 25

<b>Installazione</b> Installation Installation	<b>Incasso parete - Incasso soffitto - Incasso terra</b> Wall recess - Ceiling recess - Ground recess Encastrement au mur - Encastrement au plafond - Encastrement au sol
<b>Materiali</b> Materials Matériels	<b>Materiale Corpo: Acciaio AISI316L   Tipo di diffusore: Vetro trasparente - Vetro satinato</b> Material: Stainless steel AISI316L   Diffuser type: Transparent glass - Frosted glass Matériel du corps: Acier inox AISI316L   Type de diffuseur: Verre transparent - Verre effet satiné
<b>Alimentazione</b> Power supply Alimentation	<b>500mA - 4,8V   12/24V</b>
<b>Versioni</b> Versions Versions	<b>Cavo Alimentazione: 1,50 metri H05RN-F 2x0,75</b> Power cable: 1.50 m H05RN-F 2x0.75 Câble d'alimentation: 1,50 m H05RN-F 2x0,75



**CNC 25**  
T



**CNC 25**  
Q



## COLOURS



**Inox Lucido**  
Polished stainless steel  
Inox brillant



**Grigio antracite RAL 7021**  
Grey anthracite RAL 7021  
Gris anthracite RAL 7021



**Corten**  
Corten  
Corten

## CNC 25 T

IP67 IK 10 20J xx9 CE UK CR 500 <sup>MS</sup> MAX °C65° <sup>MAX</sup>	LED		REAL LM	COL.	CODE *
	W	LM			
	2	180	Max 148	⊠ ⊗ 500mA-4,8V	LL119000□□
					LL119004□□
					LL119006□□
	2	180	Max 148	⊠ ⊗ 12/24V	LL119001□□
					LL119005□□
					LL119007□□

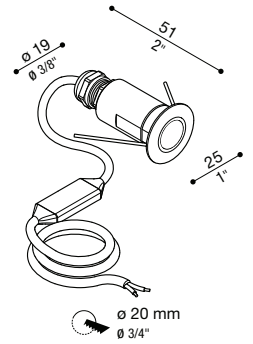

\* Complete the CODE    ○ OPTIC   M | 30°   S | 15°   D | Diff.   □ LED COLOUR   N | 4000K   3 | 3000K   2 | 2700K   B | Blue

Idoneo per installazione in tubo corrugato standard Ø25 mm. | Suitable for installation in standard Ø 25 mm corrugated duct. | Convient pour une installation dans un tube annelé standard Ø25 mm.

## CNC 25 Q

IP67 IK 10 20J xx9 CE UK CR 500 <sup>MS</sup> MAX °C65° <sup>MAX</sup>	LED		REAL LM	COL.	CODE *
	W	LM			
	2	180	Max 148	⊠ ⊗ 500mA-4,8V	LL119002□□
					LL119003□□

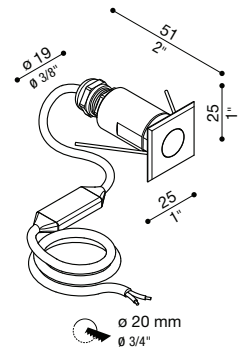

\* Complete the CODE    ○ OPTIC   M | 30°   S | 15°   D | Diff.   □ LED COLOUR   N | 4000K   3 | 3000K   2 | 2700K   B | Blue

Idoneo per installazione in tubo corrugato standard Ø25 mm. | Suitable for installation in standard Ø 25 mm corrugated duct. | Convient pour une installation dans un tube annelé standard Ø25 mm.

## Cavo H05RN-F 2x0,75

**Cavo H05RN-F in Neoprene, sezione 2x0,75. Adatto ad uso esterno.**

**Cable type H05RN-F 2x0,75**

Cable type H05RN-F in Neoprene, section 2x0.75. Suitable for outdoor use.

**Câble H05RN-F 2x0,75**

Câble H05RN-F en Néoprène, section 2x0,75. Également adapté à l'usage à l'extérieur.

**5m**

**Code**

LB1070004

**15m**

**Code**

LB1070006

**10m**

**Code**

LB1070005

**20m**

**Code**

LB1070007

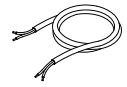

## Armatura da incasso CNC25

**Armatura da incasso in termoplastico.**

**Thermoplastic recess box CNC25**

Thermoplastic recess box.

**Armature à encastrer CNC25**

Armature à encastrer en matériau thermoplastique.

**CoL. Code**

- | LB1190001

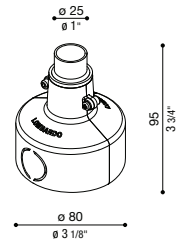

## Alimentatori CNC 25-35 in corrente costante

**CNC 25-35 ballasts in constant current**

**350mA**

**N° max**

**IP**

**Code**

**Alimentations CNC 25-35 en courant constant**

1/2

20

LB1070008

1/4

20

LB1070009

5/10

20

LB1070011

1/2 1-10V PUSH

20

LB1070012

5/10

67

LB1070014

2/4

67

LB1070013

2/9 DALI

20

LB1070064

**500mA**

**N° max**

**IP**

**Code**

1/2

20

LB1070015

1/4

20

LB1070016

5/10

20

LB1070018

1/12 1-10V PUSH

20

LB1070019

1/4

67

LB1070020

5/10

67

LB1070021

2/9 DALI

20

LB1070064

1/7 1-10V PUSH

20

LB1070043

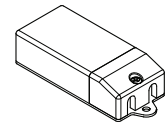

## Alimentatori CNC 25-35 in tensione costante 12/24V

**CNC 25-35 ballasts in constant tension 12/24V**

**12V**

**N° max**

**IP**

**Code**

**Alimentations CNC 25-35 en tension 12/24V**

1/6

20

LB1070025

1/12

20

LB1070026

1/8

67

LB1070027

1/15

67

LB1070028

**24V**

**N° max**

**IP**

**Code**

1/6

20

LB1070029

1/12

20

LB1070030

1/8

67

LB1070031

1/15

67

LB1070032

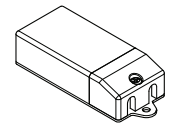



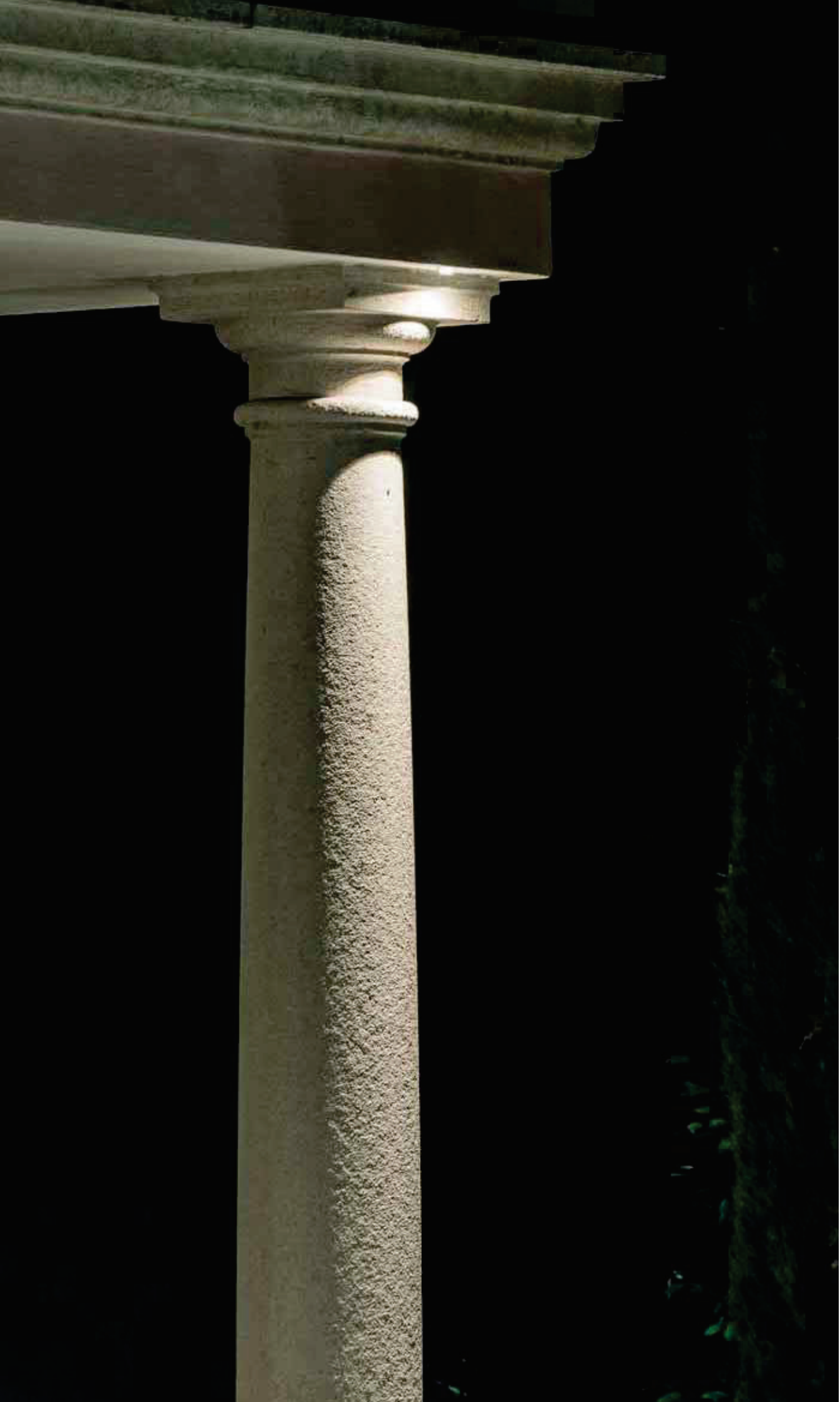

# CNC 35

**Installazione**  
Installation  
Installation

**Incasso parete - Incasso soffitto - Incasso terra - Terra - Parete**  
Wall recess - Ceiling recess - Ground recess - Ground - Wall  
Encastrement au mur - Encastrement au plafond - Encastrement au sol - Sol - Mur

**Materiali**  
Materials  
Materiels

**Materiale Corpo: Acciaio AISI316L | Tipo di diffusore: Vetro trasparente - Vetro satinato**  
Material: Stainless steel AISI316L | Diffuser type: Transparent glass - Frosted glass  
Matériel du corps: Acier inox AISI316L | Type de diffuseur: Verre transparent - Verre effet satiné

**Alimentazione**  
Power supply  
Alimentation

**500mA - 4,8V | 12/24V**

**Versioni**  
Versions  
Versions

**Cavo Alimentazione: 1,50 metri H05RN-F 2x0,75**  
Power cable: 1.50 m H05RN-F 2x0.75  
Câble d'alimentation: 1,50 m H05RN-F 2x0,75



**CNC 35**  
T



**CNC 35**  
T UP



**CNC 35**  
Q



**CNC 35**  
Q UP



**CNC 35**  
TOP S



**CNC 35**  
TOP L



**CNC 35**  
MASK



**CNC 35**  
SWING



**CNC 35**  
SWING SPOT

## COLOURS



**Inox Lucido**  
Polished stainless steel  
Inox brillant



**Grigio antracite RAL 7021**  
Grey anthracite RAL 7021  
Gris anthracite RAL 7021



**Corten**  
Corten  
Corten

## CNC 35 T

<b>IP67 IK 10 20J xx9</b> CE UK CR 500 <sup>NS</sup> 500 <sup>MAX</sup> °C65 <sup>°</sup> MAX 	LED		W	LM	REAL LM	COL.	CODE *
	2	180	Max 148	◇ ⊗ 500mA-4,8V	□	LL107000	□
				◇ ⊗ 12/24V	□	LL107006	□
					□	LL107032	□

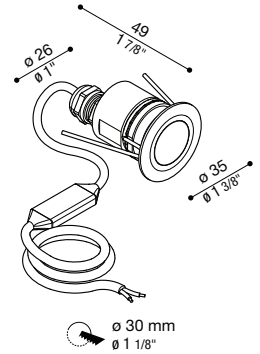

\* Complete the CODE  OPTIC S | 14° M | 29° L | 46° D | Diff.  LED COLOUR N | 4000K 3 | 3000K 2 | 2700K B | Blue

## CNC 35 T Up

<b>IP67 IK 10 20J xx9</b> CE UK CR 1000 <sup>NS</sup> 1000 <sup>MAX</sup> °C65 <sup>°</sup> MAX 	LED		W	LM	REAL LM	COL.	CODE *
	2	180	78	◇ ⊗ 500mA-4,8V	□	LL107024	□

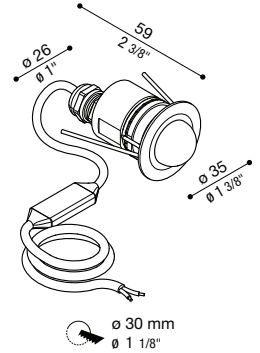

\* Complete the CODE  LED COLOUR N | 4000K 3 | 3000K 2 | 2700K B | Blue

Versione con diffusore in vetro sporgente ad alta diffusione. | Version with protruding glass diffuser for high diffusion. | Version avec diffuseur en verre saillant à diffusion élevée.

## CNC 35 Q

<b>IP67 IK 10 20J xx9</b> CE UK CR 500 <sup>NS</sup> 500 <sup>MAX</sup> °C65 <sup>°</sup> MAX 	LED		W	LM	REAL LM	COL.	CODE *
	2	180	Max 148	◇ ⊗ 500mA-4,8V	□	LL107001	□

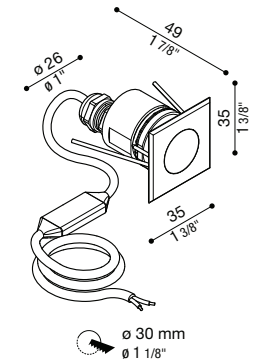

\* Complete the CODE  OPTIC S | 14° M | 29° L | 46° D | Diff.  LED COLOUR N | 4000K 3 | 3000K 2 | 2700K B | Blue

## CNC 35 Q Up

IP67 IK 10 20J xx9 CE UK CR 1000 <sup>KG</sup> MAX °C 65 <sup>°</sup> MAX	LED		REAL LM	COL.	CODE *
	W	LM			
	2	180	78	500mA-4,8V	LL107026
	2	180	78	12/24V	LL107027

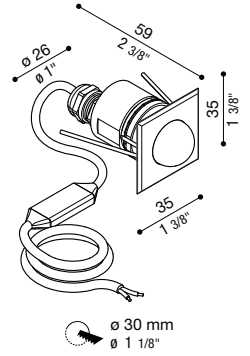

\* Complete the CODE  LED COLOUR N | 4000K 3 | 3000K 2 | 2700K B | Blue

Versione con diffusore in vetro sporgente ad alta diffondenza. | Version with protruding glass diffuser for high diffusion. | Version avec diffuseur en verre saillant à diffusion élevée.

## CNC 35 Top S

IP67 IK 10 20J xx9 CE UK CR 500 <sup>KG</sup> MAX °C 65 <sup>°</sup> MAX	LED		REAL LM	COL.	CODE *
	W	LM			
	2	180	12	500mA-4,8V	LL107002
	2	180	12	12/24V	LL107008

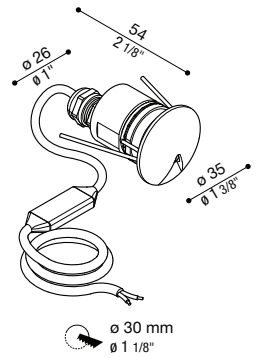

\* Complete the CODE  LED COLOUR N | 4000K 3 | 3000K 2 | 2700K B | Blue

Versione ghiera Top con apertura a 45°. | Version with Top retaining ring with 45° opening. | Version avec virole Top ouverture à 45°.

## CNC 35 Top L

IP67 IK 10 20J xx9 CE UK CR 500 <sup>KG</sup> MAX °C 65 <sup>°</sup> MAX	LED		REAL LM	COL.	CODE *
	W	LM			
	2	180	25	500mA-4,8V	LL107003
	2	180	25	12/24V	LL107009

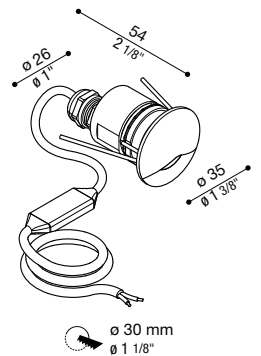

\* Complete the CODE  LED COLOUR N | 4000K 3 | 3000K 2 | 2700K B | Blue

Versione ghiera top con apertura a 135°. | Version with Top retaining ring with 135° opening. | Version avec virole Top ouverture à 135°.

## CNC 35 Mask

IP67 IK 10 20J xx9 CE UK CR 500 <sup>MS</sup> °C65 <sup>°</sup> MAX	LED		REAL LM	COL.	CODE *
	W	LM			
	2	180	21	500mA-4,8V	LL107004□
	2	180	21	12/24V	LL107010□

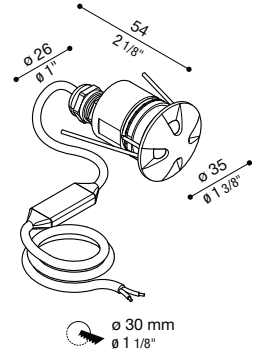

\* Complete the CODE □ LED COLOUR N | 4000K 3 | 3000K 2 | 2700K B | Blue

Versione ghiera Mask con 4 aperture da 35°. | Version with Mask retaining ring with four 35° openings. | Version avec virole Mask 4 ouvertures à 35°.

## CNC 35 Swing

IP67 IK 07 2J xx5 CE UK CR °C65 <sup>°</sup> MAX	LED		REAL LM	COL.	CODE *
	W	LM			
	2	180	Max 148	500mA-4,8V	LL107005□□
					LL107036□□
					LL107037□□
	2	180	Max 148	12/24V	LL107011□□
					LL107038□□
					LL107039□□

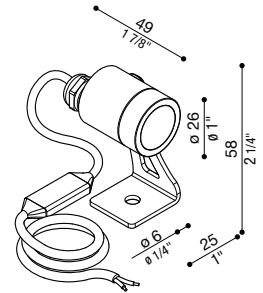

\* Complete the CODE □ OPTIC S | 14° M | 29° L | 46° D | Diff. □ LED COLOUR N | 4000K 3 | 3000K 2 | 2700K B | Blue

Versione orientabile. Picchetto non incluso. | Swivel version. Stake not included. | Version orientable. Piquet non compris.

## CNC 35 Swing Spot

IP67 IK 07 2J xx5 CE UK CR °C65 <sup>°</sup> MAX	LED		REAL LM	COL.	CODE *
	W	LM			
	2	180	Max 148	500mA-4,8V	LL107028□
	2	180	Max 148	12/24V	LL107029□

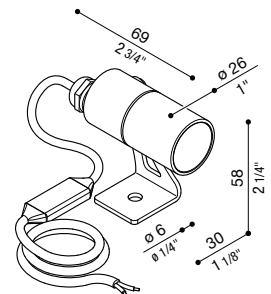

\* Complete the CODE □ LED COLOUR N | 4000K 3 | 3000K 2 | 2700K B | Blue

Versione orientabile antiabbagliamento. Picchetto non incluso. | Adjustable anti-glare version. Stake not included. | Version orientable antiéblouissement. Piquet non compris.

### Cavo H05RN-F 2x0,75

**Cavo H05RN-F in Neoprene, sezione 2x0,75. Adatto ad uso esterno.**

**Cable type H05RN-F 2x0,75**

Cable type H05RN-F in Neoprene, section 2x0.75. Suitable for outdoor use.

**Câble H05RN-F 2x0,75**

Câble H05RN-F en Néoprène, section 2x0,75. Également adapté à l'usage à l'extérieur.

**5m**

**Code**

**LB1070004**

**10m**

**Code**

**LB1070005**

**15m**

**Code**

**LB1070006**

**20m**

**Code**

**LB1070007**

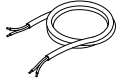

### Armatura da incasso CNC/INC 35

**Armatura da incasso in termoplastico.**

**Thermoplastic recess box CNC/INC 35**

Thermoplastic recess box.

**Armature à encastrer CNC/INC 35**

Armature à encastrer en matériau thermoplastique.

**Col.**

**Code**

-

**LB1070001**

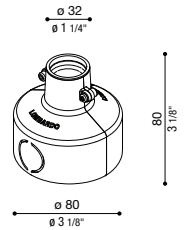

### Accessorio giardino - CNC35 - CNC50

**Accessorio da giardino da abbinare a CNC35 Swing / CNC50 Swing, realizzato in metallo zincato a freddo. Adatto per uso esterno. Idoneo per installazione a terra.**

**Garden accessory - CNC35 - CNC50**

Garden accessory for use with CN C35 Swing / CNC50 Swing, made of cold galvanized metal. Suitable for outdoor use and ground application.

**Accessoire de jardin - CNC35 - CNC50**

Accessoire de jardin à associer à CNC35 Swing / CNC50 Swing, réalisé en métal zingué à froid. Également adapté à l'usage à l'extérieur. Convient pour une utilisation au sol.

**Col.**

**Code**

-

**LB1070002**

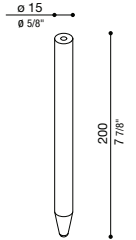

### Alimentatori CNC 25-35 in corrente costante

**CNC 25-35 ballasts in constant current**

**350mA**

**N° max**

**IP**

**Code**

1/2	20	LB1070008
1/4	20	LB1070009
5/10	20	LB1070011
1/2 1-10V PUSH	20	LB1070012
2/4	67	LB1070013
5/10	67	LB1070014
2/9 DALI	20	LB1070064

**500mA**

**N° max**

**IP**

**Code**

1/2	20	LB1070015
1/4	20	LB1070016
5/10	20	LB1070018
1/2 1-10V PUSH	20	LB1070019
1/4	67	LB1070020
5/10	67	LB1070021
2/9 DALI	20	LB1070064
1/7 1-10V PUSH	20	LB1070043

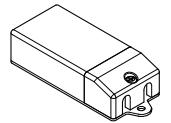

### Alimentatori CNC 25-35 in tensione costante 12/24V

**CNC 25-35 ballasts in constant tension 12/24V**

**12V**

**N° max**

**IP**

**Code**

1/6	20	LB1070025
1/12	20	LB1070026
1/8	67	LB1070027
1/15	67	LB1070028

**24V**

**N° max**

**IP**

**Code**

1/6	20	LB1070029
1/12	20	LB1070030
1/8	67	LB1070031
1/15	67	LB1070032

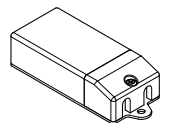



## FEATURES



**Versioni colorate  
disponibili su richiesta.**  
Coloured versions  
available on request.  
Disponible sur demande  
versions colorées.















CNC 35



# CNC 49

<b>Installazione</b> Installation Installation	<b>Incasso terra - Incasso parete - Terra - Parete</b> Ground recess - Wall recess - Ground - Wall Encastrement au sol - Encastrement au mur - Sol - Mur
<b>Materiali</b> Materials Materiels	<b>Materiale Corpo: Alluminio   Tipo di diffusore: PMMA - Policarbonato</b> Material: Aluminium   Diffuser type: PMMA - Polycarbonate Matériel du corps: Aluminium   Type de diffuseur: PMMA - Polycarbonate
<b>Alimentazione</b> Power supply Alimentation	<b>24V</b>
<b>Versioni</b> Versions Versions	<b>Cavo Alimentazione: 0,50 metri H05RN-F 2x0,75</b> Power cable: 0.50 m H05RN-F 2x0.75 Câble d'alimentation: 0,50 m H05RN-F 2x0,75

 <b>CNC 49</b> CL	 <b>CNC 49</b> C2L	 <b>CNC 49</b> C4L	     
 <b>CNC 49</b> C180	 <b>CNC 49</b> QL	 <b>CNC 49</b> Q2L	
 <b>CNC 49</b> Q4L			

**COLOURS**

 <b>Inox Lucido</b> Polished stainless steel Inox brillant	 <b>Bianco RAL 9010</b> White RAL 9010 Blanc RAL 9010	 <b>Grigio High Tech RAL 9006</b> Grey High Tech RAL 9006 Gris High Tech RAL 9006	 <b>Grigio antracite RAL 7021</b> Grey anthracite RAL 7021 Gris anthracite RAL 7021	 <b>Corten</b> Corten Corten
--	---	---	---	--



NEW

### CNC 49 CL

<b>IP67 IK 10 20J xx9</b> <small>500<sup>RG</sup> MAX 53°C MAX CE UK CR</small>	LED			COL.	CODE *	
	W	LM	REAL LM			
	2	240	26		<input type="checkbox"/> LL127000 <input type="checkbox"/> LL12700W <input type="checkbox"/> LL12700G <input type="checkbox"/> LL12700E <input type="checkbox"/> LL12700K	
					<input type="checkbox"/> LL127000 <input type="checkbox"/> LL12700W <input type="checkbox"/> LL12700G <input type="checkbox"/> LL12700E <input type="checkbox"/> LL12700K	

\* Complete the CODE     LED COLOUR    N | 4000K    3 | 3000K    2 | 2700K

### CNC 49 C2L

NEW

<b>IP67 IK 10 20J xx9</b> <small>500<sup>RG</sup> MAX 53°C MAX CE UK CR</small>	LED			COL.	CODE *	
	W	LM	REAL LM			
	2	240	45		<input type="checkbox"/> LL127010 <input type="checkbox"/> LL12701W <input type="checkbox"/> LL12701G <input type="checkbox"/> LL12701E <input type="checkbox"/> LL12701K	
					<input type="checkbox"/> LL127010 <input type="checkbox"/> LL12701W <input type="checkbox"/> LL12701G <input type="checkbox"/> LL12701E <input type="checkbox"/> LL12701K	

\* Complete the CODE     LED COLOUR    N | 4000K    3 | 3000K    2 | 2700K

### CNC 49 C4L

NEW

<b>IP67 IK 10 20J xx9</b> <small>500<sup>RG</sup> MAX 53°C MAX CE UK CR</small>	LED			COL.	CODE *	
	W	LM	REAL LM			
	2	240	83		<input type="checkbox"/> LL127020 <input type="checkbox"/> LL12702W <input type="checkbox"/> LL12702G <input type="checkbox"/> LL12702E <input type="checkbox"/> LL12702K	
					<input type="checkbox"/> LL127020 <input type="checkbox"/> LL12702W <input type="checkbox"/> LL12702G <input type="checkbox"/> LL12702E <input type="checkbox"/> LL12702K	

\* Complete the CODE     LED COLOUR    N | 4000K    3 | 3000K    2 | 2700K

### CNC 49 C180

NEW

<b>IP67 IK 10 20J xx9</b> <small>500<sup>RG</sup> MAX 53°C MAX CE UK CR</small>	LED			COL.	CODE *	
	W	LM	REAL LM			
	2	240	37		<input type="checkbox"/> LL127030 <input type="checkbox"/> LL12703W <input type="checkbox"/> LL12703G <input type="checkbox"/> LL12703E <input type="checkbox"/> LL12703K	
					<input type="checkbox"/> LL127030 <input type="checkbox"/> LL12703W <input type="checkbox"/> LL12703G <input type="checkbox"/> LL12703E <input type="checkbox"/> LL12703K	

\* Complete the CODE     LED COLOUR    N | 4000K    3 | 3000K    2 | 2700K

Versione a 180° | 180° version. | Version 180°.

### CNC 49 QL

NEW

<b>IP67 IK 10 20J xx9</b> <small>500<sup>RG</sup> MAX 53°C MAX CE UK CR</small>	LED			COL.	CODE *	
	W	LM	REAL LM			
	2	240	26		<input type="checkbox"/> LL127100 <input type="checkbox"/> LL12710W <input type="checkbox"/> LL12710G <input type="checkbox"/> LL12710E <input type="checkbox"/> LL12710K	
					<input type="checkbox"/> LL127100 <input type="checkbox"/> LL12710W <input type="checkbox"/> LL12710G <input type="checkbox"/> LL12710E <input type="checkbox"/> LL12710K	

\* Complete the CODE     LED COLOUR    N | 4000K    3 | 3000K    2 | 2700K

## CNC 49 Q2L

IP67 IK 10 20J xx9 500 <sup>RG</sup> MAX 53°C MAX CE UK CR	LED			COL.	CODE *	
	W	LM	REAL LM			
	2	240	45		LL127110□ LL12711W□ LL12711G□ LL12711E□ LL12711K□	

\* Complete the CODE  LED COLOUR N | 4000K 3 | 3000K 2 | 2700K

## CNC 49 Q4L

IP67 IK 10 20J xx9 500 <sup>RG</sup> MAX 53°C MAX CE UK CR	LED			COL.	CODE *	
	W	LM	REAL LM			
	2	240	83		LL127120□ LL12712W□ LL12712G□ LL12712E□ LL12712K□	

\* Complete the CODE  LED COLOUR N | 4000K 3 | 3000K 2 | 2700K

## Accessori | Accessories | Accessoires

### Cavo H05RN-F 2x0,75

Cavo H05RN-F in Neoprene, sezione 2x0,75. Adatto ad uso esterno.

Cable type H05RN-F 2x0,75

Cable type H05RN-F in Neoprene, section 2x0.75. Suitable for outdoor use.

Câble H05RN-F 2x0,75

Câble H05RN-F en Néoprène, section 2x0,75. Également adapté à l'usage à l'extérieur.

5m Code	15m Code
LB1070004	LB1070006
10m Code	20m Code
LB1070005	LB1070007



### Armatura da incasso CNC/INC 35

Armatura da incasso in termoplastico.

Thermoplastic recess box CNC/INC 35

Thermoplastic recess box.

Armature à encastrer CNC/INC 35

Armature à encastrer en matériau thermoplastique.

CoL.	Code
-	LB1070001

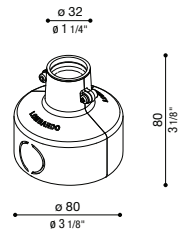

### Alimentatori CNC 49 in tensione costante 24V

CNC 49 ballasts in constant tension 24V

Alimentations CNC 49 en tension 24V

N° max	IP	Code
1/10	20	LB1070029
1/16	20	LB1070030
1/13	67	LB1070031
1/20	67	LB1070032
1/7 DALI	20	LB1070065

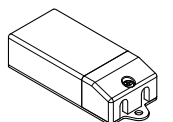



CNC 49 C2L

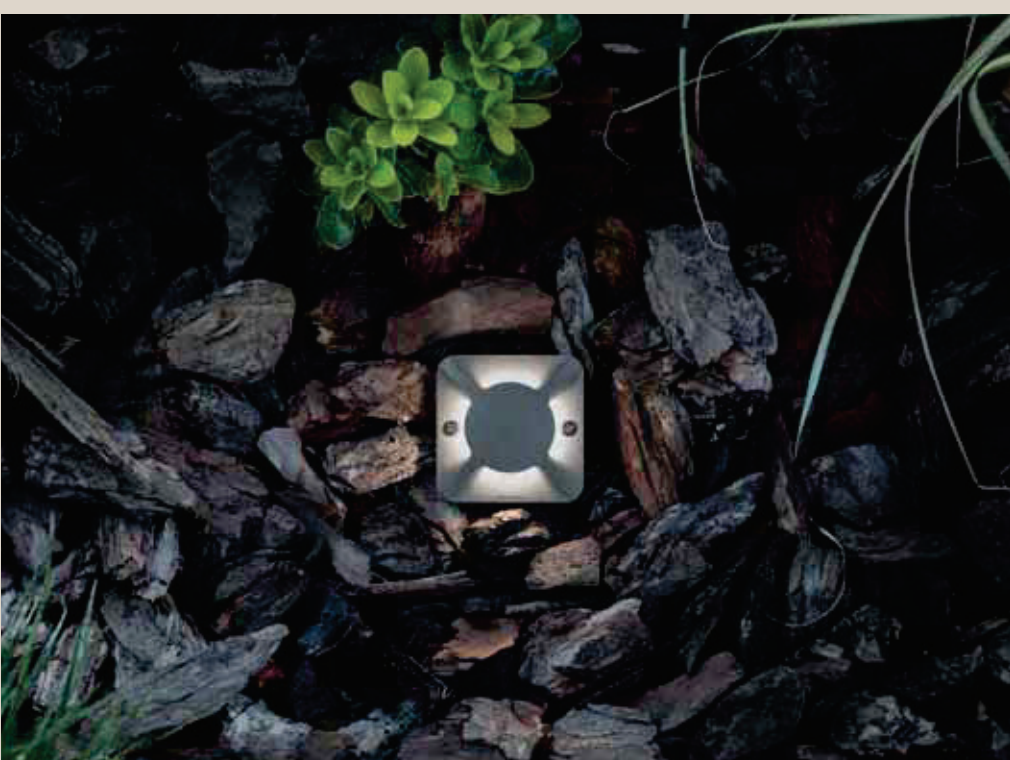

CNC 49 Q4L

# CNC 50

<b>Installazione</b> Installation Installation	<b>Incasso parete - Incasso soffitto - Incasso terra - Terra - Parete</b> Wall recess - Ceiling recess - Ground recess - Ground - Wall Encastrement au mur - Encastrement au plafond - Encastrement au sol - Sol - Mur
<b>Materiali</b> Materials Materiels	<b>Materiale Corpo: Acciaio AISI316L   Tipo di diffusore: Vetro trasparente - Vetro satinato</b> Material: Stainless steel AISI316L   Diffuser type: Transparent glass - Frosted glass Matériel du corps: Acier inox AISI316L   Type de diffuseur: Verre transparent - Verre effet satiné
<b>Alimentazione</b> Power supply Alimentation	<b>500mA - 14V   24V</b>
<b>Versioni</b> Versions Versions	<b>Cavo Alimentazione: 1,50 metri H05RN-F 2x0,75</b> Power cable: 1.50 m H05RN-F 2x0.75 Câble d'alimentation: 1,50 m H05RN-F 2x0,75



**CNC 50**  
T



**CNC 50**  
T UP



**CNC 50**  
TOP L



**CNC 50**  
TOP 2L



**CNC 50**  
SWING



**CNC 50**  
SWING SPOT



## COLOURS



**Inox Lucido**  
Polished stainless steel  
Inox brillant



**Grigio antracite RAL 7021**  
Grey anthracite RAL 7021  
Gris anthracite RAL 7021



**Corten**  
Corten  
Corten

## CNC 50 T

<b>IP67 IK 10 20J xx9</b> <small>CE UK CR 500<sup>KG</sup> MAX °C65<sup>°</sup> MAX</small>	LED		W	LM	REAL LM		COL.	CODE *	
		<input type="checkbox"/>	<input type="checkbox"/>	6,5	650	Max 427	<input checked="" type="checkbox"/> <input checked="" type="checkbox"/>	<b>500mA-14V</b>	<input type="checkbox"/> <b>LL107016</b>
									<input type="checkbox"/> <b>LL107040</b>
									<input type="checkbox"/> <b>LL107041</b>
		<input type="checkbox"/>	<input type="checkbox"/>	6,5	650	Max 427	<input checked="" type="checkbox"/> <input checked="" type="checkbox"/>	<b>24V</b>	<input type="checkbox"/> <b>LL107017</b>
									<input type="checkbox"/> <b>LL107042</b>
<input type="checkbox"/> <b>LL107043</b>									

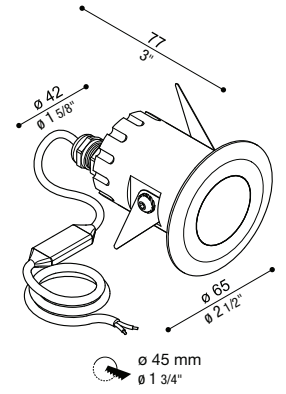

\* Complete the CODE     OPTIC    S | 13°    M | 24°    L | 53°    D | Diff.     LED COLOUR    N | 4000K    3 | 3000K    2 | 2700K

## CNC 50 T Up

<b>IP67 IK 10 20J xx9</b> <small>CE UK CR 450<sup>KG</sup> MAX °C65<sup>°</sup> MAX</small>	LED		W	LM	REAL LM		COL.	CODE *	
		<input type="checkbox"/>	<input type="checkbox"/>	6,5	650	269	<input checked="" type="checkbox"/> <input checked="" type="checkbox"/>	<b>500mA-14V</b>	<input type="checkbox"/> <b>LL107022</b>
									<input type="checkbox"/> <b>LL107023</b>
		<input type="checkbox"/>	<input type="checkbox"/>	6,5	650	269	<input checked="" type="checkbox"/> <input checked="" type="checkbox"/>	<b>24V</b>	<input type="checkbox"/> <b>LL107022</b>
<input type="checkbox"/> <b>LL107023</b>									

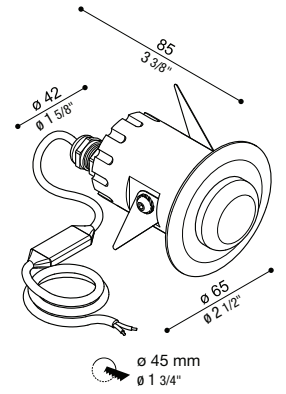

\* Complete the CODE     LED COLOUR    N | 4000K    3 | 3000K    2 | 2700K

Versione con diffusore in vetro sporgente ad alta diffondenza. | Version with protruding glass diffuser for high diffusion. | Version avec diffuseur en verre saillant à diffusion élevée.

## CNC 50 Top L

<b>IP67 IK 10 20J xx9</b> <small>CE UK CR °C65<sup>°</sup> MAX 2000<sup>KG</sup> MAX</small>	LED		W	LM	REAL LM		COL.	CODE *	
		<input type="checkbox"/>	<input type="checkbox"/>	6,5	650	260	<input checked="" type="checkbox"/> <input checked="" type="checkbox"/>	<b>500mA-14V</b>	<input type="checkbox"/> <b>LL107018</b>
									<input type="checkbox"/> <b>LL107019</b>
		<input type="checkbox"/>	<input type="checkbox"/>	6,5	650	260	<input checked="" type="checkbox"/> <input checked="" type="checkbox"/>	<b>24V</b>	<input type="checkbox"/> <b>LL107018</b>
<input type="checkbox"/> <b>LL107019</b>									

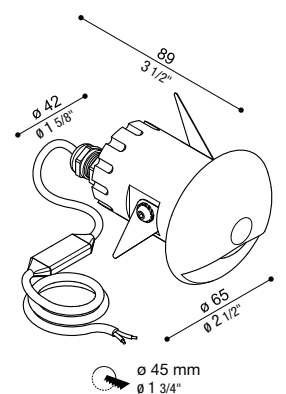

\* Complete the CODE     LED COLOUR    N | 4000K    3 | 3000K    2 | 2700K

Versione ghiera top con apertura a 110°. | Version with Top retaining ring with 110° opening. | Version avec virole Top ouverture à 110°.

## CNC 50 Top 2L

IP67 IK 10 20J xx9 CE UK RA 2000 <sup>KG</sup> °C 65 <sup>°</sup> MAX	LED		REAL LM	COL.	CODE *
	W	LM			
	6,5	650	453	500mA-14V	LL107020□
	6,5	650	453	24V	LL107021□

\* Complete the CODE □ LED COLOUR N | 4000K 3 | 3000K 2 | 2700K

Versione ghiera con 2 aperture da 110°. | Version with Top retaining ring with two 110° openings. | Version avec virole Top 2 ouvertures à 110°.

## CNC 50 Swing

IP67 IK 07 2J xx5 CE UK RA °C 65 <sup>°</sup> MAX	LED		REAL LM	COL.	CODE *
	W	LM			
	6,5	650	Max 427	500mA-14V	LL107012□□
					LL107044□□
					LL107045□□
	6,5	650	Max 427	24V	LL107013□□
					LL107046□□
					LL107047□□

\* Complete the CODE ○ OPTIC S | 13° M | 24° L | 53° D | Diff. □ LED COLOUR N | 4000K 3 | 3000K 2 | 2700K

Versione orientabile. Picchetto non incluso. | Swivel version. Stake not included. | Version orientable. Piquet non compris.

## CNC 50 Swing Spot

IP67 IK 07 2J xx5 CE UK RA °C 65 <sup>°</sup> MAX	LED		REAL LM	COL.	CODE *
	W	LM			
	6,5	650	Max 488	500mA-14V	LL107030□
	6,5	650	Max 488	24V	LL107031□

\* Complete the CODE □ LED COLOUR N | 4000K 3 | 3000K 2 | 2700K

Versione orientabile antiabbagliamento. Picchetto non incluso. | Adjustable anti-glare version. Stake not included. | Version orientable antiéblouissement. Piquet non compris.



## Cavo H05RN-F 2x0,75

**Cavo H05RN-F in Neoprene, sezione 2x0,75. Adatto ad uso esterno.**

**Cable type H05RN-F 2x0,75**

Cable type H05RN-F in Neoprene, section 2x0.75. Suitable for outdoor use.

**Câble H05RN-F 2x0,75**

Câble H05RN-F en Néoprène, section 2x0,75. Également adapté à l'usage à l'extérieur.

**5m**

**Code**

LB1070004

**15m**

**Code**

LB1070006

**10m**

**Code**

LB1070005

**20m**

**Code**

LB1070007



## Armatura da incasso CNC 50

**Armatura da incasso in termoplastico.**

**Recess box CNC 50**

Thermoplastic recess box.

**Boîte d'encastrement CNC 50**

Armature à encastrer en matériau thermoplastique.

**Col.**

**Code**

-

LB1070039

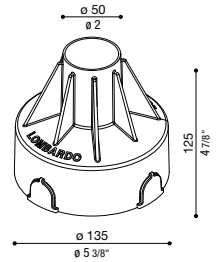

## Accessorio giardino - CNC35 - CNC50

**Accessorio da giardino da abbinare a CNC35 Swing / CNC50 Swing, realizzato in metallo zincato a freddo. Adatto per uso esterno. Idoneo per installazione a terra.**

**Garden accessory - CNC35 - CNC50**

Garden accessory for use with CN C35 Swing / CNC50 Swing, made of cold galvanized metal. Suitable for outdoor use and ground application.

**Accessoire de jardin - CNC35 - CNC50**

Accessoire de jardin à associer à CNC35 Swing / CNC50 Swing, réalisé en métal zingué à froid. Également adapté à l'usage à l'extérieur. Convient pour une utilisation au sol.

**Col.**

**Code**

-

LB1070002

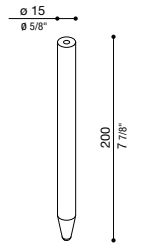

## Alimentatori CNC 50 in corrente costante

**CNC 50 ballasts in constant current**

**350mA**

**N° max**

**IP**

**Code**

**500mA**

**N° max**

**IP**

**Code**

**Alimentations CNC 50 en courant constant**

1	20	LB1070009
1/3	20	LB1070011
1/3 1-10V PUSH	20	LB1070012
1/2	67	LB1070013
1/3	67	LB1070014
1/3 DALI	20	LB1070064

1	20	LB1070016
1/3	20	LB1070018
1/3 1-10V PUSH	20	LB1070019
1/2	67	LB1070020
2/4	67	LB1070021
1/3 DALI	20	LB1070064

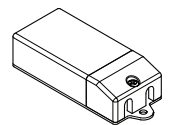

## Alimentatori CNC 50 in tensione costante 24V

**CNC 50 ballasts in constant tension 24V available**

**N° max**

**IP**

**Code**

**Alimentations CNC 50 en tension 24V**

1/2	20	LB1070029
1/4	20	LB1070030
1/5	67	LB1070031
1/7	67	LB1070032

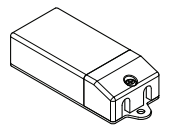

# CNC 99

<b>Installazione</b> Installation Installation	<b>Parete - Soffitto - Terra - Incasso terra</b> Wall - Ceiling - Ground - Ground recess Mur - Plafond - Sol - Encastrement au sol
<b>Materiali</b> Materials Materiels	<b>Materiale Corpo: Alluminio   Tipo di diffusore: PMMA - Policarbonato</b> Material: Aluminium   Diffuser type: PMMA - Polycarbonate Matériel du corps: Aluminium   Type de diffuseur: PMMA - Polycarbonate
<b>Alimentazione</b> Power supply Alimentation	<b>24V</b>
<b>Versioni</b> Versions Versions	<b>Cavo Alimentazione: 0,50 metri H05RN-F 2x0,75</b> Power cable: 0.50 m H05RN-F 2x0.75 Câble d'alimentation: 0,50 m H05RN-F 2x0,75



**CNC 99**  
CL



**CNC 99**  
C2L



**CNC 99**  
C4L



**CNC 99**  
C180



**CNC 99**  
C UP



**CNC 99**  
QL



**CNC 99**  
Q2L



**CNC 99**  
Q4L



## COLOURS



**Inox Lucido**  
Polished stainless steel  
Inox brillant



**Bianco RAL 9010**  
White RAL 9010  
Blanc RAL 9010



**Grigio High Tech RAL 9006**  
Grey High Tech RAL 9006  
Gris High Tech RAL 9006



**Grigio antracite RAL 7021**  
Grey anthracite RAL 7021  
Gris anthracite RAL 7021



**Corten**  
Corten  
Corten



## CNC 99 CL

<b>IP67 IK 10 20J xx9</b> Ⓢ 2000 <sup>KG</sup> MAX 53°C MAX CE UK CR	LED			COL.	CODE *	
	W	LM	REAL LM			
	5	470	45	LL137000□ LL13700W□ LL13700G□ LL13700E□ LL13700K□	24V	

\* Complete the CODE  LED COLOUR N | 4000K 3 | 3000K 2 | 2700K

Cod. LL137000N/3/2 ghiera in acciaio inox. Se installato con armatura cod. LB1230001, il prodotto è calpestabile. | Cod. LL137000N/3/2 stainless steel retaining ring. When installed with recess box code LB1230001, the product is walk-over. | Cod. LL137000N/3/2 collerette en acier inox. Lorsqu'il est installé avec le code d'armature LB1230001, le produit est praticable.

## CNC 99 C2L

<b>IP67 IK 10 20J xx9</b> Ⓢ 2000 <sup>KG</sup> MAX 53°C MAX CE UK CR	LED			COL.	CODE *	
	W	LM	REAL LM			
	5	470	100	LL137010□ LL13701W□ LL13701G□ LL13701E□ LL13701K□	24V	

\* Complete the CODE  LED COLOUR N | 4000K 3 | 3000K 2 | 2700K

Cod. LL137010N/3/2 ghiera in acciaio inox. Se installato con armatura cod. LB1230001, il prodotto è calpestabile. | Bidirectional version. Cod. LL137010N/3/2 stainless steel retaining ring. When installed with recess box code LB1230001, the product is walk-over. | Cod. LL137010N/3/2 collerette en acier inox. Lorsqu'il est installé avec le code d'armature LB1230001, le produit est praticable.

## CNC 99 C4L

<b>IP67 IK 10 20J xx9</b> Ⓢ 2000 <sup>KG</sup> MAX 53°C MAX CE UK CR	LED			COL.	CODE *	
	W	LM	REAL LM			
	5	470	200	LL137020□ LL13702W□ LL13702G□ LL13702E□ LL13702K□	24V	

\* Complete the CODE  LED COLOUR N | 4000K 3 | 3000K 2 | 2700K

Cod. LL137020N/3/2 ghiera in acciaio inox. Se installato con armatura cod. LB1230001, il prodotto è calpestabile. | Cod. LL137020N/3/2 stainless steel retaining ring. When installed with recess box code LB1230001, the product is walk-over. | Cod. LL137020N/3/2 collerette en acier inox. Lorsqu'il est installé avec le code d'armature LB1230001, le produit est praticable.

## CNC 99 C180

<b>IP67 IK 10 20J xx9</b> Ⓢ 2000 <sup>KG</sup> MAX 53°C MAX CE UK CR	LED			COL.	CODE *	
	W	LM	REAL LM			
	5	470	93	LL137030□ LL13703W□ LL13703G□ LL13703E□ LL13703K□	24V	

\* Complete the CODE  LED COLOUR N | 4000K 3 | 3000K 2 | 2700K

Versione a 180°. Cod. LL137030N/3/2 ghiera in acciaio inox. Se installato con armatura cod. LB1230001, il prodotto è calpestabile. | 180° version. Cod. LL137030N/3/2 stainless steel retaining ring. When installed with recess box code LB1230001, the product is walk-over. | Version 180°. Cod. LL137030N/3/2 collerette en acier inox. Lorsqu'il est installé avec le code d'armature LB1230001, le produit est praticable.

## CNC 99 C UP

<b>IP67 IK 10 20J xx9</b> ⚡ 500 <sup>KG</sup> MAX 53°C MAX CE UK CR 	LED			COL.	CODE *	
	W	LM	REAL LM			
5	470	173	⊠ ⊗ 24V	<input type="checkbox"/> LL137040 <input type="checkbox"/> LL13704W <input type="checkbox"/> LL13704G <input type="checkbox"/> LL13704E <input type="checkbox"/> LL13704K		

\* Complete the CODE  LED COLOUR N | 4000K 3 | 3000K 2 | 2700K

Cod. LL137040N/3/2 ghiera in acciaio inox. Diffusore in policarbonato, effetto poliGLASS. | Cod. LL137040N/3/2 stainless steel retaining ring. Polycarbonate diffuser, polyGLASS effect. | Cod. LL137040N/3/2 collerette en acier inox. Diffuseur en polycarbonate, effet polyGLASS.

## CNC 99 QL

NEW

<b>IP67 IK 10 20J xx9</b> ⚡ 2000 <sup>KG</sup> MAX 53°C MAX CE UK CR 	LED			COL.	CODE *	
	W	LM	REAL LM			
5	470	52	⊠ ⊗ 24V	<input type="checkbox"/> LL13710W <input type="checkbox"/> LL13710G <input type="checkbox"/> LL13710E <input type="checkbox"/> LL13710K		

\* Complete the CODE  LED COLOUR N | 4000K 3 | 3000K 2 | 2700K

Se installato con armatura cod. LB1230001, il prodotto è calpestabile. | When installed with recess box code LB1230001, the product is walk-over. | Lorsqu'il est installé avec le code d'armature LB1230001, le produit est praticable.

## CNC 99 Q2L

NEW

<b>IP67 IK 10 20J xx9</b> ⚡ 2000 <sup>KG</sup> MAX 53°C MAX CE UK CR 	LED			COL.	CODE *	
	W	LM	REAL LM			
5	470	98	⊠ ⊗ 24V	<input type="checkbox"/> LL13711W <input type="checkbox"/> LL13711G <input type="checkbox"/> LL13711E <input type="checkbox"/> LL13711K		

\* Complete the CODE  LED COLOUR N | 4000K 3 | 3000K 2 | 2700K

Se installato con armatura cod. LB1230001, il prodotto è calpestabile. | When installed with recess box code LB1230001, the product is walk-over. | Lorsqu'il est installé avec le code d'armature LB1230001, le produit est praticable.

## CNC 99 Q4L

NEW

<b>IP67 IK 10 20J xx9</b> ⚡ 2000 <sup>KG</sup> MAX 53°C MAX CE UK CR 	LED			COL.	CODE *	
	W	LM	REAL LM			
5	470	170	⊠ ⊗ 24V	<input type="checkbox"/> LL13712W <input type="checkbox"/> LL13712G <input type="checkbox"/> LL13712E <input type="checkbox"/> LL13712K		

\* Complete the CODE  LED COLOUR N | 4000K 3 | 3000K 2 | 2700K

Se installato con armatura cod. LB1230001, il prodotto è calpestabile. | When installed with recess box code LB1230001, the product is walk-over. | Lorsqu'il est installé avec le code d'armature LB1230001, le produit est praticable.

### Cavo H05RN-F 2x0,75

**Cavo H05RN-F in Neoprene, sezione 2x0,75. Adatto ad uso esterno.**

**Cable type H05RN-F 2x0,75**

Cable type H05RN-F in Neoprene, section 2x0.75. Suitable for outdoor use.

**Câble H05RN-F 2x0,75**

Câble H05RN-F en Néoprène, section 2x0,75. Également adapté à l'usage à l'extérieur.

**5m**

**Code**

**LB1070004**

**10m**

**Code**

**LB1070005**

**15m**

**Code**

**LB1070006**

**20m**

**Code**

**LB1070007**

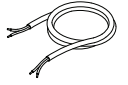

### Armatura da incasso CNC100

**Armatura da incasso in termoplastico.**

**Thermoplastic recess box CNC100**

Thermoplastic recess box.

**Armature à encastrer CNC100**

Armature à encastrer en matériau thermoplastique.

**CoL.**

**Code**

-

**LB1230001**

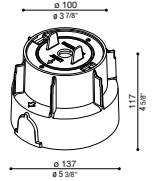

### Alimentatori CNC 99 in tensione costante 24V

**CNC 99 ballasts in constant tension 24V**

N° max	IP	Code
1/5	20	LB1070029
1/8	20	LB1070030
1/5	67	LB1070031

**Alimentations CNC 99 en tension 24V**

N° max	IP	Code
1/10	67	LB1070032
1/6 DALI	20	LB1070065

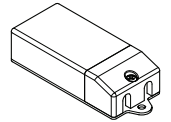

## FEATURES

**Finto incasso.**  
Surface mounted.  
Faux encastré.

**Cavo di alimentazione**  
Power cable  
Câble d'alimentation

**Pavimentazione**  
Floor  
Sol

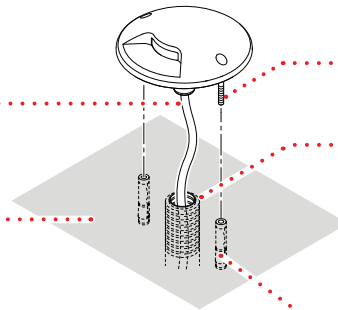

**Tasselli M4**  
Anchor screws M4  
Chevilles M4

**Tubo corrugato**  
Corrugated duct  
Tube annelé

**Fissaggio tramite tasselli ad espansione ø8 mm**  
Fixing by means of anchor screws ø8 mm  
Fixation par chevilles à expansion ø8 mm



**Versioni disponibili.**  
Available versions.  
Versions disponibles.

**\* Versione in acciaio inox.**  
Stainless steel version.  
Version en acier inox.





CNC 99 C4L



CNC 99 C1



CNC 99 Q1



CNC 99 Q2L



# CNC 100

<b>Installazione</b> Installation Installation	<b>Incasso parete - Incasso terra - Terra</b> Wall recess - Ground recess - Ground Encastrement au mur - Encastrement au sol - Sol
<b>Materiali</b> Materials Materiels	<b>Materiale Corpo: Alluminio   Tipo di diffusore: Policarbonato</b> Material: Aluminium   Diffuser type: Polycarbonate Matériel du corps: Aluminium   Type de diffuseur: Polycarbonate
<b>Alimentazione</b> Power supply Alimentation	<b>220-240 V   700mA - 3,10V   700mA - 6,20V   AC DIRECT</b>
<b>Versioni</b> Versions Versions	<b>Cavo Alimentazione: 1,50 metri H05RN-F 3×1 - 1,50 metri H05RN-F 2×0,75</b> Power cable: 1.50 m H05RN-F 3×1 - 1.50 m H05RN-F 2×0.75 Câble d'alimentation: 1,50 m H05RN-F 3×1 - 1,50 m H05RN-F 2×0,75



**CNC 100**  
L



**CNC 100**  
2L



**CNC 100**  
UP



**CNC 100**  
CL



**CNC 100**  
C2L



**CNC 100**  
C-UP



## COLOURS



**Acciaio Inox Elettrolucidato**  
Stainless steel electropolished  
Acier inoxydable électropoli



**Bianco RAL 9010**  
White RAL 9010  
Blanc RAL 9010



**Grigio High Tech RAL 9006**  
Grey High Tech RAL 9006  
Gris High Tech RAL 9006



**Grigio antracite RAL 7021**  
Grey anthracite RAL 7021  
Gris anthracite RAL 7021



**Corten**  
Corten  
Corten

## CNC 100 L

<b>IP67 IK 10 20J xx9</b> CE UK CRA I@ 2000 <sup>KG</sup> MAX 50°C MAX 	LED			COL.	CODE *	
	W	LM	REAL LM			
3	215	103	⊕ ⊙ 220-240 V	<input type="checkbox"/> LL123000 <input type="checkbox"/> LL123001 <input type="checkbox"/> LL123002 <input type="checkbox"/> LL123003 <input type="checkbox"/> LL123004		

\* Complete the CODE  LED COLOUR N | 4000K 3 | 3000K 2 | 2700K

Versione ghiera top con apertura a 110°. Cavo H05RN-F 3×1. | Version with Top retaining ring with 110° opening. Cable type H05RN-F 3×1. | Version avec virole Top ouverture à 110°. Câble H05RN-F 3×1.

## CNC 100 2L

<b>IP67 IK 10 20J xx9</b> CE UK CRA I@ 2000 <sup>KG</sup> MAX 50°C MAX 	LED			COL.	CODE *	
	W	LM	REAL LM			
5	430	205	⊕ ⊙ 220-240 V	<input type="checkbox"/> LL123005 <input type="checkbox"/> LL123006 <input type="checkbox"/> LL123007 <input type="checkbox"/> LL123008 <input type="checkbox"/> LL123009		

\* Complete the CODE  LED COLOUR N | 4000K 3 | 3000K 2 | 2700K

Versione ghiera con 2 aperture da 110°. Cavo H05RN-F 3×1. | Version with Top retaining ring with two 110° openings. Cable type H05RN-F 3×1. | Version avec virole Top 2 ouvertures à 110°. Câble H05RN-F 3×1.

## CNC 100 UP

<b>IP67 IK 10 20J xx9</b> CE UK CRA I@ 280 <sup>KG</sup> MAX 50°C MAX 	LED			COL.	CODE *	
	W	LM	REAL LM			
4	400	217	⊕ ⊙ 220-240 V	<input type="checkbox"/> LL123010 <input type="checkbox"/> LL123011 <input type="checkbox"/> LL123012 <input type="checkbox"/> LL123013 <input type="checkbox"/> LL123014		

\* Complete the CODE  LED COLOUR N | 4000K 3 | 3000K 2 | 2700K

Emissione luminosa a 120°. Cavo H05RN-F 3×1. | Light beam 120°. Cable type H05RN-F 3×1. | Angle de diffusion 120°. Câble H05RN-F 3×1.

## CNC 100 CL

IP67 IK 10 20J xx9 CE UK CA 2000 <sup>KG</sup> 50°C <sup>MAX</sup>	LED			COL.	CODE *	
	W	LM	REAL LM			
 Fino ad esaurimento. Until our stock lasts. Jusqu'à épuisement de stock.	3	215	103		LL123015	
					LL123016	
					LL123017	
					LL123018	
					LL123019	
* Complete the CODE <input type="checkbox"/> LED COLOUR    N   4000K    3   3000K    2   2700K						

Versione ghiera top con apertura a 110°. Completo di kit di fissaggio tramite tasselli ad espansione Ø8 mm. Cavo H05RN-F 2x0,75. | Version with Top retaining ring with 110° opening. Complete with fixing kit by means of anchor screws Ø8 mm. Cable type H05RN-F 2x0,75. | Version avec virole Top ouverture à 110°. Complet de kit de fixation par chevilles à expansion Ø8 mm. Câble H05RN-F 2x0,75.

## CNC 100 C2L

IP67 IK 10 20J xx9 CE UK CA 2000 <sup>KG</sup> 50°C <sup>MAX</sup>	LED			COL.	CODE *	
	W	LM	REAL LM			
 Fino ad esaurimento. Until our stock lasts. Jusqu'à épuisement de stock.	5	430	205		LL123020	
					LL123021	
					LL123022	
					LL123023	
					LL123024	
* Complete the CODE <input type="checkbox"/> LED COLOUR    N   4000K    3   3000K    2   2700K						

Versione ghiera con 2 aperture da 110°. Completo di kit di fissaggio tramite tasselli ad espansione Ø8 mm. Cavo H05RN-F 2x0,75. | Version with Top retaining ring with two 110° openings. Complete with fixing kit by means of anchor screws Ø8 mm. Cable type H05RN-F 2x0,75. | Version avec virole Top 2 ouvertures à 110°. Complet de kit de fixation par chevilles à expansion Ø8 mm. Câble H05RN-F 2x0,75.

## CNC 100 C-UP

IP67 IK 10 20J xx9 CE UK CA 280 <sup>KG</sup> 50°C <sup>MAX</sup>	LED			COL.	CODE *	
	W	LM	REAL LM			
 Fino ad esaurimento. Until our stock lasts. Jusqu'à épuisement de stock.	4	400	217		LL123025	
					LL123026	
					LL123027	
					LL123028	
					LL123029	
* Complete the CODE <input type="checkbox"/> LED COLOUR    N   4000K    3   3000K    2   2700K						

Emissione luminosa a 120°. Completo di kit di fissaggio tramite tasselli ad espansione Ø8 mm. Cavo H05RN-F 3x1. | Light beam 120°. Complete with fixing kit by means of anchor screws Ø8 mm. Cable type H05RN-F 3x1. | Angle de diffusion 120°. Complet de kit de fixation par chevilles à expansion Ø8 mm. Câble H05RN-F 3x1.



## Cavo H05RN-F CNC 3x1

**Cavo H05RN-F in Neoprene, sezione 3x1. Adatto ad uso esterno.**

**Cable type H05RN-F 3x1**

Cable type H05RN-F in Neoprene, section 3X1. Suitable for outdoor use.

**Câble H05RN-F 3x1**

Câble H05RN-F en Néoprène, section 3X1. Également adapté à l'usage à l'extérieur.

**5m**

**Code**

**LB1070054**

**10m**

**Code**

**LB1070055**

**15m**

**Code**

**LB1070056**

**20m**

**Code**

**LB1070057**

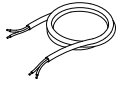

## Cavo H05RN-F 2x0,75

**Cavo H05RN-F in Neoprene, sezione 2x0,75. Adatto ad uso esterno.**

**Cable type H05RN-F 2x0,75**

Cable type H05RN-F in Neoprene, section 2x0.75. Suitable for outdoor use.

**Câble H05RN-F 2x0,75**

Câble H05RN-F en Néoprène, section 2x0,75. Également adapté à l'usage à l'extérieur.

**5m**

**Code**

**LB1070004**

**10m**

**Code**

**LB1070005**

**15m**

**Code**

**LB1070006**

**20m**

**Code**

**LB1070007**

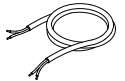

## Armatura da incasso CNC100

**Armatura da incasso in termoplastico.**

**Thermoplastic recess box CNC100**

Thermoplastic recess box.

**Armature à encastrer CNC100**

Armature à encastrer en matériau thermoplastique.

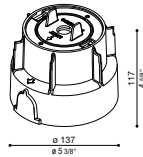

Col.	Code
-	LB1230001

## Alimentatori CNC 100 in corrente costante

**CNC100 ballasts in constant current**

**Alimentations CNC100 en courant constant**

N° max	IP	Code
1	67	LB1070041
1/4	67	LB1070059
1/4 1-10V PUSH	20	LB1070043
1/6 DALI	20	LB1070064

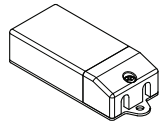

## FEATURES

**Incasso.**  
Recessed.  
À encastrer.

**Alimentatore**  
Driver  
Ballast

**Molla per ancoraggio**  
Reting springs  
Ressort pour ancrage

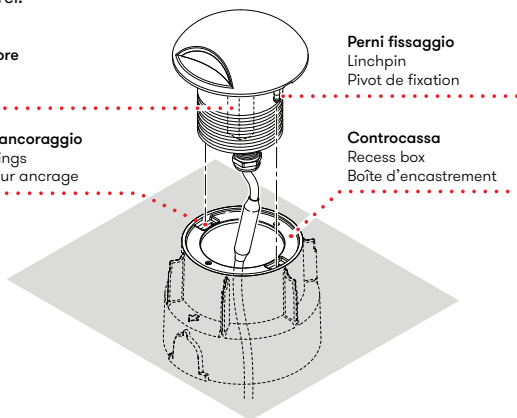

**Finto incasso.**  
Surface mounted.  
Faux encastré.

**Cavo di alimentazione**  
Power cable  
Câble d'alimentation

**Pavimentazione**  
Floor  
Sol

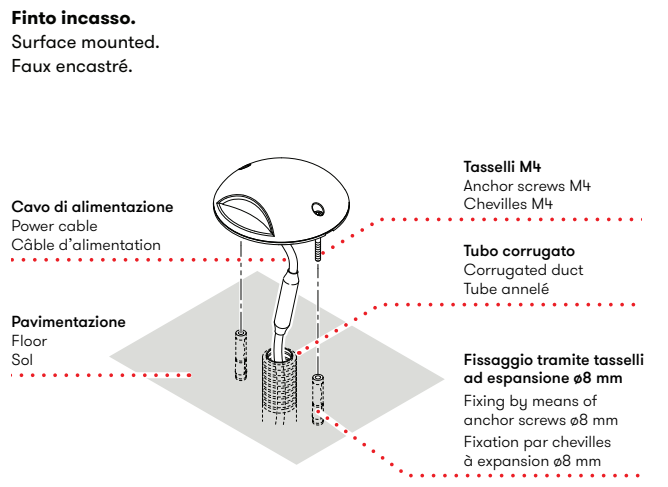

**Led a tensione di rete.**  
LED AC Direct.  
LED Direct AC.



**Led posto verticalmente.**  
LED vertically mounted.  
LED monté verticalment.



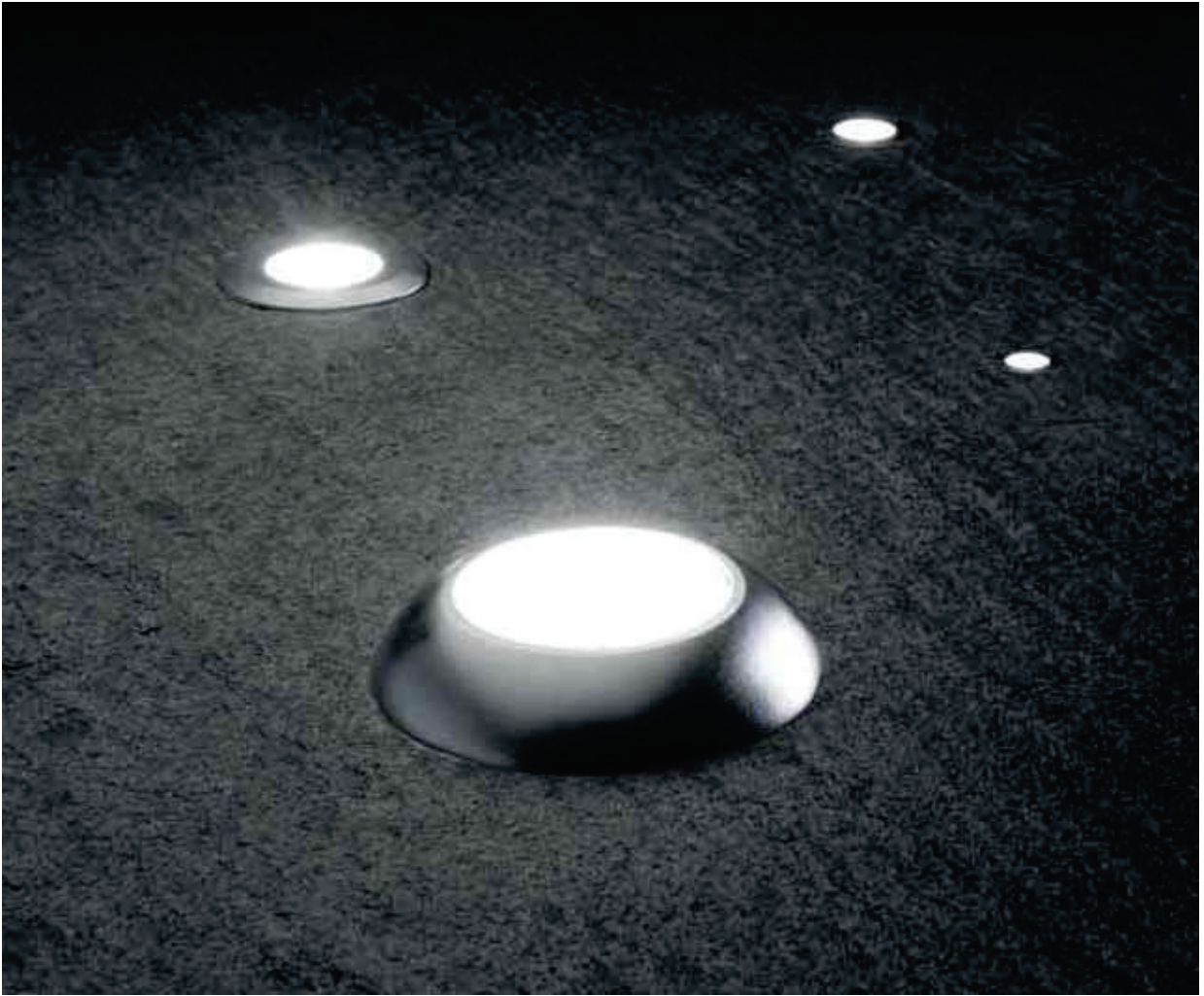





# CNC 120

<b>Installazione</b> Installation Installation	<b>Incasso terra</b> Ground recess Encastrement au sol
<b>Materiali</b> Materials Matériels	<b>Materiale Corpo: Alluminio   Tipo di diffusore: Vetro serigrafato</b> Material: Aluminium   Diffuser type: Serigraphed glass Matériel du corps: Aluminium   Type de diffuseur: Verre sérigraphié
<b>Alimentazione</b> Power supply Alimentation	<b>700mA - 12V   12/24V</b>
<b>Versioni</b> Versions Versions	<b>Cavo Alimentazione: 1,50 metri H05RN-F 2x0,75</b> Power cable: 1.50 m H05RN-F 2x0.75 Câble d'alimentation: 1,50 m H05RN-F 2x0,75



**CNC 120**  
T



## COLOURS



**Inox Spazzolato**  
Brushed grey  
Inox brossé

# CNC 120 T

IP67 IK 10 20J xx9 CE UK CR 10 2000 <sup>RG</sup> MAX °C 60 <sup>o</sup> MAX	LED							
	W	LM	REAL LM		COL.	CODE *		
	9	1000	750	700mA-12V		LL131000		
	9	1000	750	12/24V		LL131100		

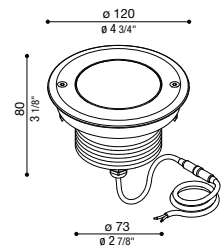

\* Complete the CODE     OPTIC     S | Spot-25°     M | 60°     A | Asymm.     D | Diff.     B | Blade     LED COLOUR     N | 4000K     3 | 3000K     2 | 2700K



### Cavo H05RN-F 2x0,75

**Cavo H05RN-F in Neoprene, sezione 2x0,75. Adatto ad uso esterno.**

**Cable type H05RN-F 2x0,75**

Cable type H05RN-F in Neoprene, section 2x0.75. Suitable for outdoor use.

**Câble H05RN-F 2x0,75**

Câble H05RN-F en Néoprène, section 2x0,75. Également adapté à l'usage à l'extérieur.

**5m**

**Code**

LB1070004

**15m**

**Code**

LB1070006

**10m**

**Code**

LB1070005

**20m**

**Code**

LB1070007

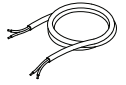

### Armatura da incasso CNC120

**Armatura da incasso in termoplastico.**

**Thermoplastic recess box CNC120**

Thermoplastic recess box.

**Armature à encastrer CNC120**

Armature à encastrer en matériau thermoplastique.

**Col.**

**Code**



LB1310001

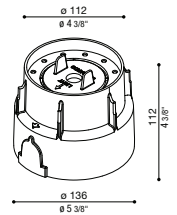

### Alimentatori CNC 120 in corrente costante

**CNC 120 ballasts in constant current**

**Alimentations CNC 120 en courant constant**

**N° max**

**IP**

**Code**

1/2

20

LB1070060

3

20

LB1070061

1/2

67

LB1070059

1/2 1-10V PUSH

20

LB1070043

1/3 DALI

20

LB1070064

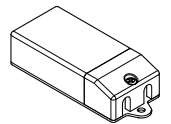

### Alimentatori CNC 120 in tensione costante 12/24V

**CNC 120 ballasts in constant tension 12/24V**

**Alimentations en tension CNC120**

**12V**

**N° max**

**IP**

**Code**

1/2

20

LB1070025

1/3

20

LB1070026

1/2

67

LB1070027

1/4

67

LB1070028

**24V**

**N° max**

**IP**

**Code**

1/3

20

LB1070029

1/5

20

LB1070030

1/4

67

LB1070031

1/6

67

LB1070032

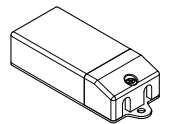



# FEATURES



↘ S Spot-25°

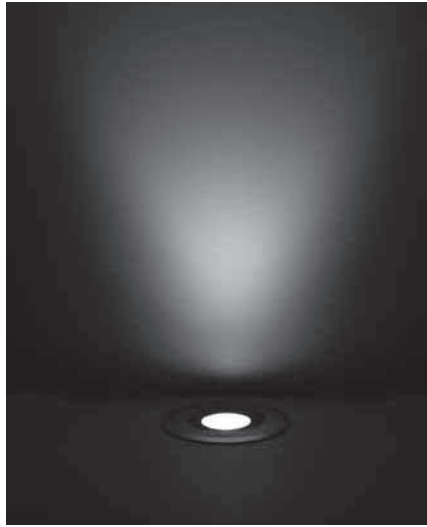

↘ M 60°

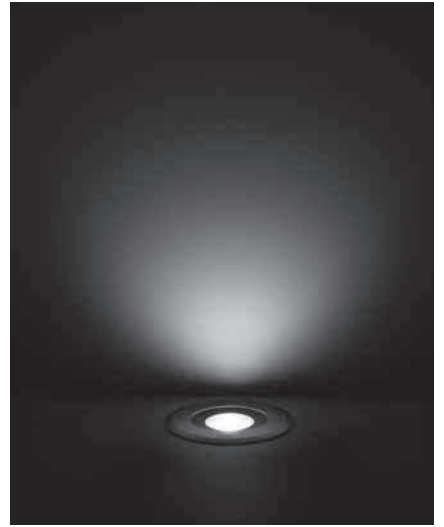

↘ D Diff.

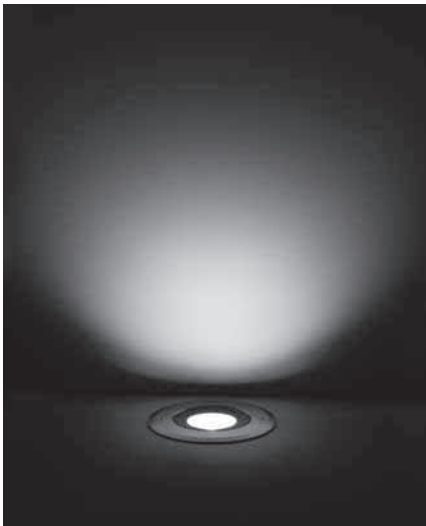

↘ A Asymm.

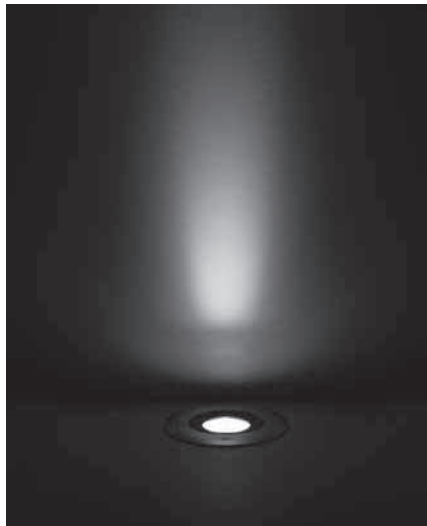

↘ B Blade

Complete the CODE

OPTIC

**Completa il codice sostituendo al cerchio grigio la lettera corrispondente al modello di ottica scelta.**

Complete the code by replacing the grey circle with the letter corresponding to the chosen optic model.

Compléter le code en remplaçant le cercle gris par la lettre correspondant au modèle de lentille choisie.



CNC 120 T

# CNC 150

## Installazione

Installation  
Installation

## Incasso terra

Ground recess  
Encastrement au sol

## Materiali

Materials  
Materiels

## Materiale Corpo: Alluminio | Tipo di diffusore: Vetro serigrafato

Material: Aluminium | Diffuser type: Serigraphed glass  
Matériel du corps: Aluminium | Type de diffuseur: Verre sérigraphié

## Alimentazione

Power supply  
Alimentation

600mA

## Versioni

Versions  
Versions

## Cavo Alimentazione: 0,50 metri H05RN-F 2x0,75

Power cable: 0.50 m H05RN-F 2x0.75  
Câble d'alimentation: 0,50 m H05RN-F 2x0,75



**CNC 150**



## COLOURS



**Inox Spazzolato**  
Brushed grey  
Inox brossé



## CNC 150

<b>IP67 IK 10 20J xx9</b> <small>CE UK CA 10 2000<sup>RG</sup> MAX 58°C<sup>MAX</sup></small>	<b>LED</b>			<b>COL.</b>	<b>CODE *</b>	
	<b>W</b>	<b>LM</b>	<b>REAL LM</b>	<b>600mA</b>		

\* Complete the CODE     OPTIC     S | 12°     M | 24°     L | 32°     LED COLOUR     N | 4000K     3 | 3000K     2 | 2700K

## Accessori | Accessories | Accessoires

### Cavo H05RN-F 2x0,75

**Cavo H05RN-F in Neoprene, sezione 2x0,75. Adatto ad uso esterno.**

**Cable type H05RN-F 2x0,75**

Cable type H05RN-F in Neoprene, section 2x0.75. Suitable for outdoor use.

**Câble H05RN-F 2x0,75**

Câble H05RN-F en Néoprène, section 2x0,75. Également adapté à l'usage à l'extérieur.

**5m**

**Code**

**LB1070004**

**15m**

**Code**

**LB1070006**

**10m**

**Code**

**LB1070005**

**20m**

**Code**

**LB1070007**

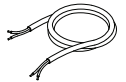

### Armatura da incasso CNC 150

**Armatura da incasso in termoplastico.**

**Recess box CNC 150**

Thermoplastic recess box.

**Armature à encastrer CNC 150**

Armature à encastrer en matériau thermoplastique.

CoL.	Code
-	LB1360001

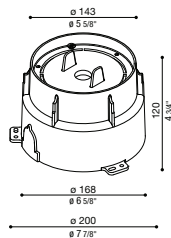

### Alimentatori CNC 150 in corrente costante

**Drivers in constant current CNC150**

**Alimentations à courant constant CNC 150**

N° max	IP	Code
1	20	LB1070063
1 DALI	20	LB1070064

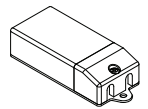

CNC 150

